

VISTELLE®

Vistelle is a highly durable, glass looking acrylic panel. It's designed to be lighter, 4 x faster and easier to install than tiles.

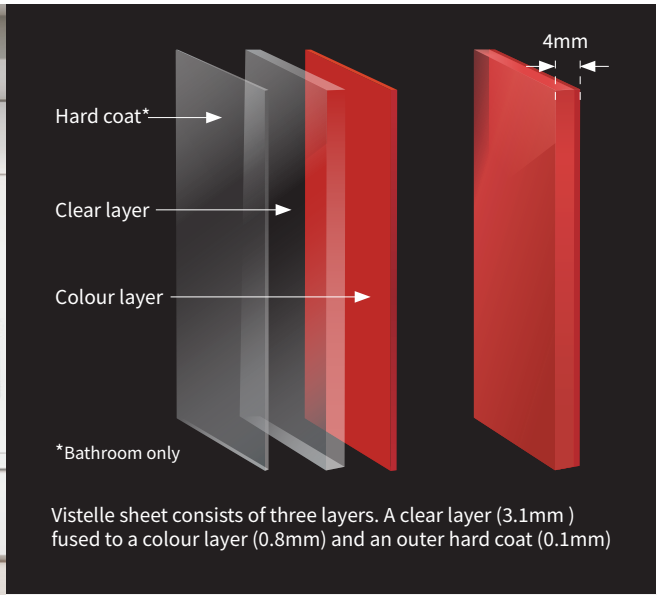

Applications



Bathroom



Kitchen splashback



Any indoor vertical surface

Key Benefits



Hard coat tested to 20,000 cleans. Will not scratch, warp, stain or discolour



25 x the impact strength of glass



Installs 4 x faster than tiles



Easy to clean



Can be cut and drilled with normal wood working tools



Eliminate grout. Large hygienic panels

Colour Range

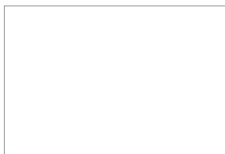

Salt

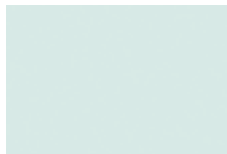

Mist



Sky



Tawny



Blush



Eclipse

Panel Sizes

Vistelle is 4 mm thick

Kitchen splashbacks

2600 x 760mm

700 x 745mm
Gas glass 6mm thick

Bath and shower walls

2070 x 900mm

2070 x 1250mm

Vanity splashbacks

900 x 300mm

1200 x 300mm

2440 x 1000mm

Installation

Can be installed over existing tiles or other wall finishes with double sided tape and neutral cure silicone. The double sided tape is essential to hold the panel in place whilst the silicone bonds.

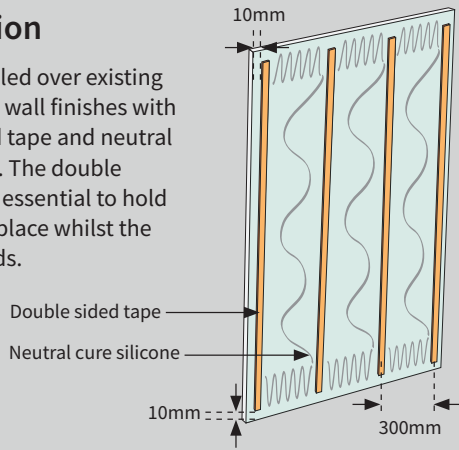

Installation Tools



Circular saw



Jig saw



Electric planer



Drill

Edges continued

Edges option 2 (with profiles):

Fitted with aluminium edge profiles:

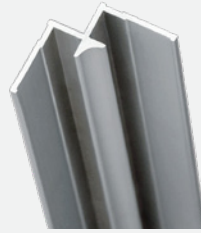

Internal Corner



Straight Joiner



External Corner



Square Edge Cap

Install kit available

One kit will install two 2440mm x 1000mm panels and 2 kits are required for a three-panel bath surround.



Neutral cure silicone tubes x 2



Double-sided tape 15m



Tile spacers x 12



Sandpaper



Silicone spatula



Cleaning Squeegee



Latex gloves x 1



Vistelle Installation Guide

Cleaning



Vistelle is easy to keep clean using warm soapy water and a microfibre cloth, chamois, or squeegee.

Its hygienic, non-stick surface will not harbour the build-up of mould, bacteria, soap, or calcium. Due to the large size of the panels grout usage is eliminated.



IMPORTANT: Do not scrub or use brushes, scrapers or harsh instruments containing metal on the cleaning surface (including steel wool) at any time. Also, abrasive cleaners should NOT be used with Vistelle.

Warranty



The Vistelle warranty covers faulty materials for a period of 10 years from the date of sale by EGR subject to the terms, conditions and exclusions contained within the entire warranty document.

Edges

Edges option 1 (without profiles)

Edges can be sanded, polished or sealed at joints using a neutral cure silicone. leave a 2, 4 or 6mm gap as required.

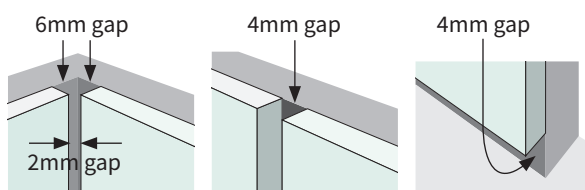

EGR Building Products Division

45 Machinery St, Darra, Brisbane
Queensland 4076, Australia

www.vistelle.com

info@vistelle.com

1800 347 347

MADE IN AUSTRALIA

